



WILSONVILLE DISTRIBUTION CENTER

Unique Cross Loaded 77,000
SF End-Cap Unit Now Available

29899 SW BOONES FERRY ROAD, WILSONVILLE, OR



WILSONVILLEDC.COM

OWNED BY

LBA Logistics 

LEASING BY

 Kidder
Mathews

SITE PLAN

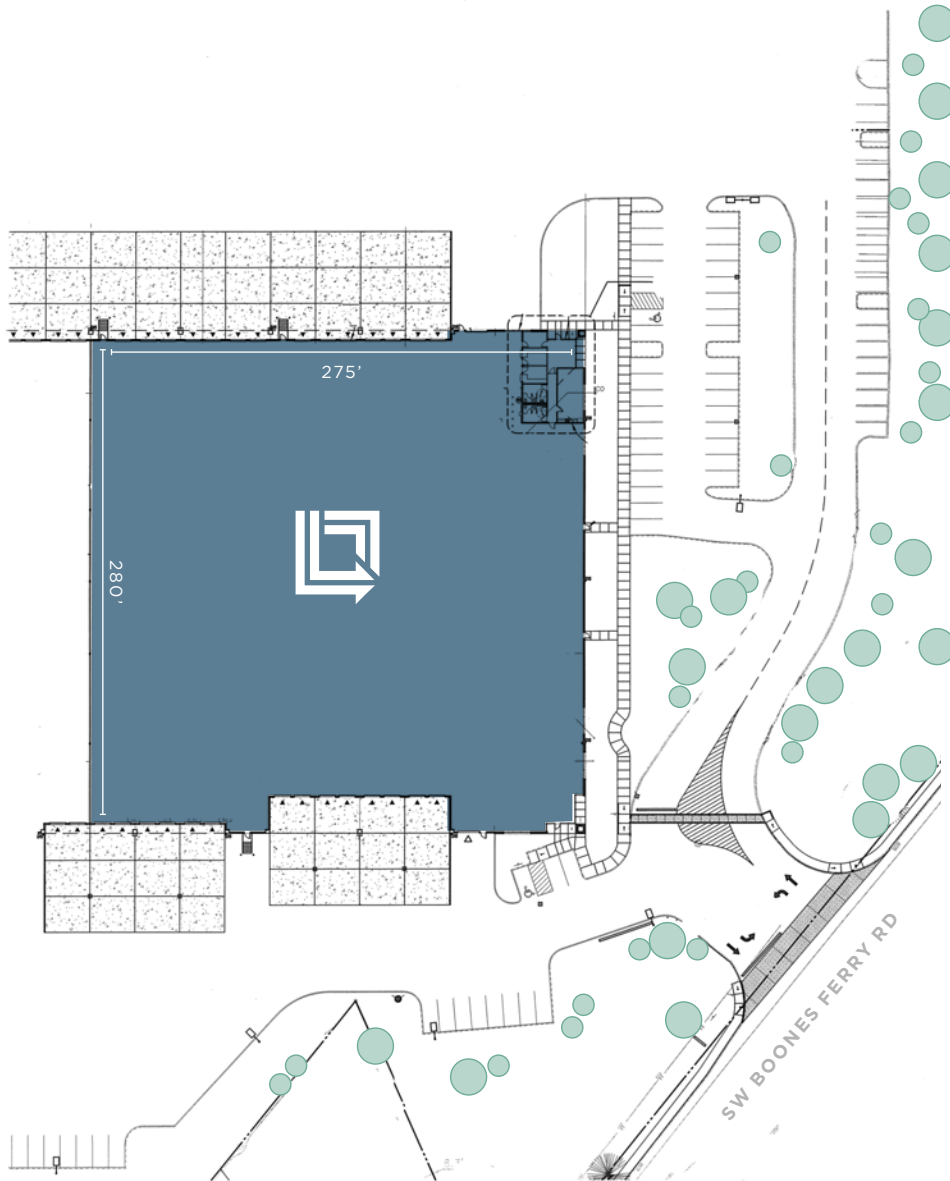

Property Summary

PROPERTY NAME	Wilsonville Distribution Center Phase II
ADDRESS	29899 SW Boones Ferry Rd, Suite 100 Wilsonville, OR
ZONING	PDI (Planned Development Industrial)
TOTAL RSF	77,000 SF
OFFICE SF	1,800 SF
SPACE LAYOUT	Cross loaded building design with dock and grade doors on both sides of building
COLUMN SPACING	50' x 50' typical with some bays larger at 62.5'
LOADING	28 dock high doors and 2 grade level doors
CONSTRUCTION	Concrete tilt-up
CLEAR HEIGHT	26'
SPRINKLERS	ESFR sprinkler system
RENTAL RATE	Call for quote



SEAMLESSLY CONNECTED

Directly adjacent to Interstate 5, Wilsonville Distribution Center is in the heart of Oregon's distribution hub providing superior connectivity



20 minutes

TO DOWNTOWN PORTLAND



3hrs 30min

TO SEATTLE



9 hours

TO SACRAMENTO



9hrs 50min

TO SAN FRANCISCO

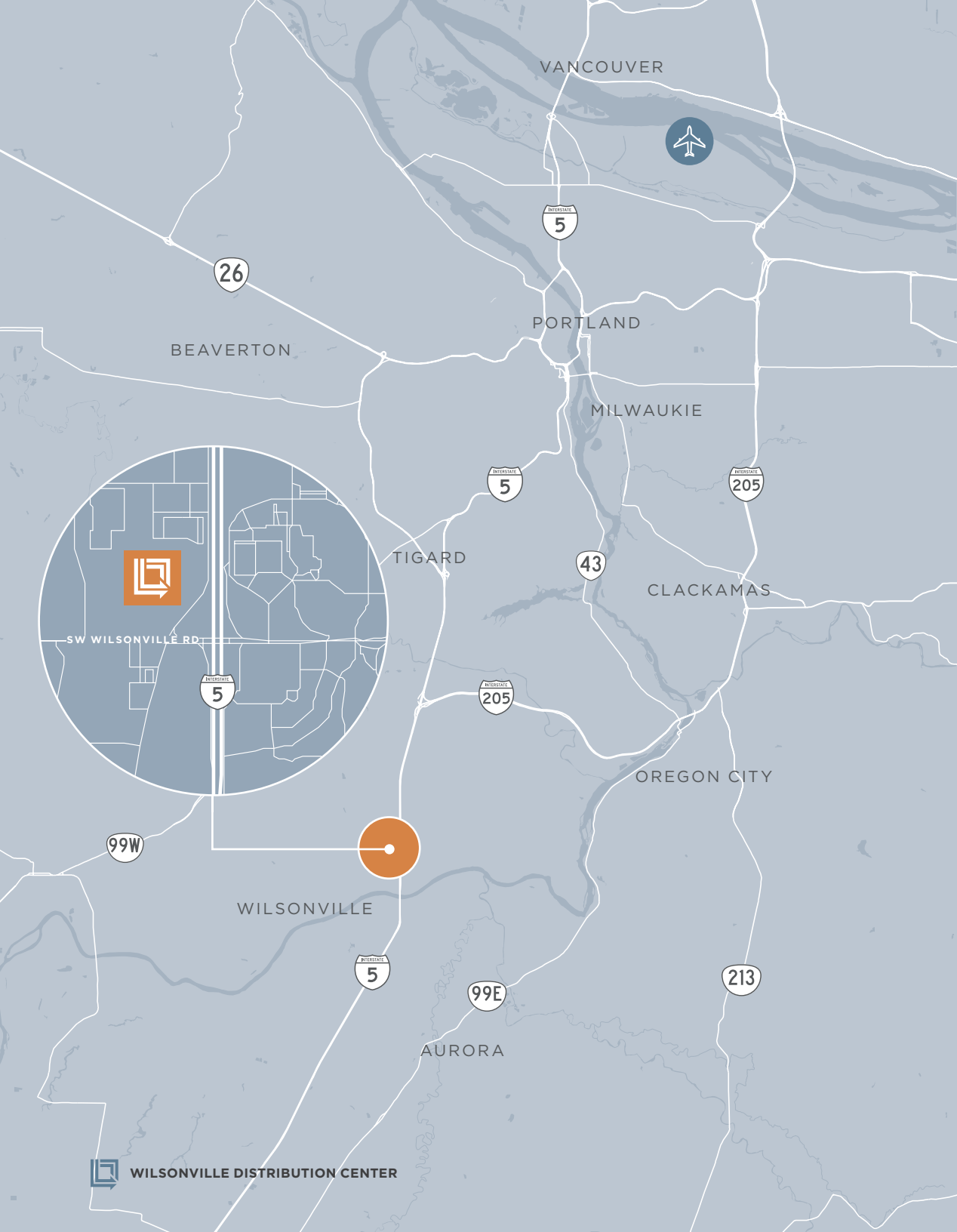

LABOR STATISTICS

DATA SOURCE: REGIS

ESTIMATED POPULATION 2022

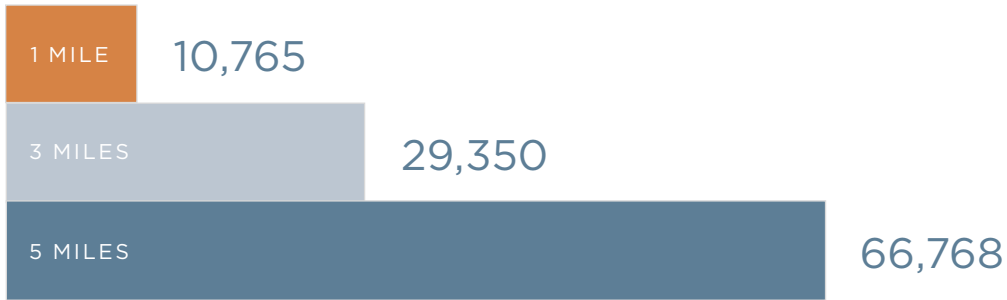

POPULATION GROWTH 2022-2027

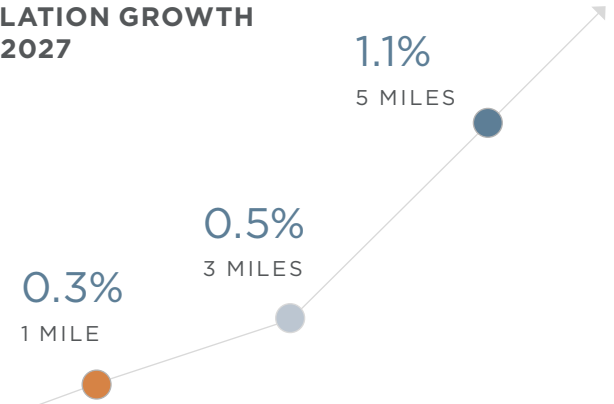

POPULATION FORECAST 2027

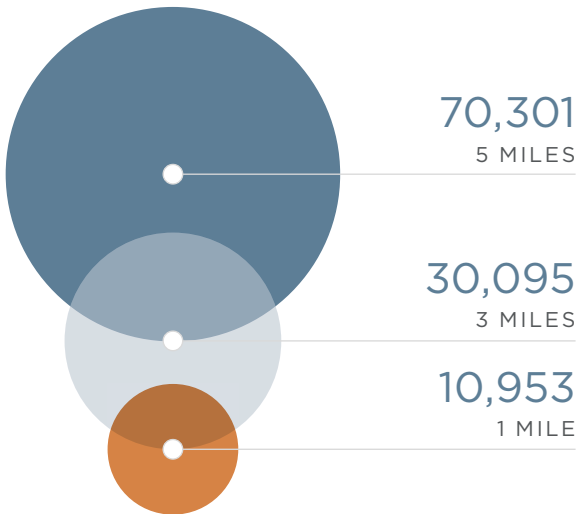

AVERAGE HOUSEHOLD INCOME 2022

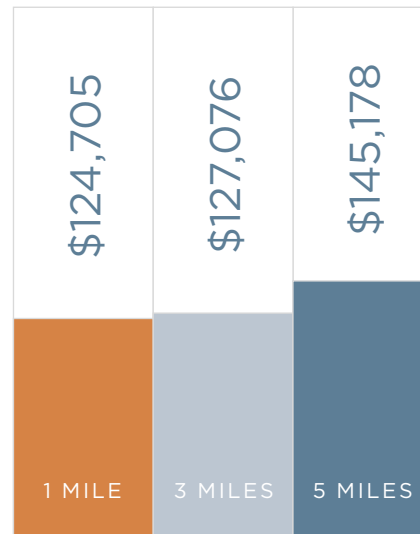

ESTIMATED EMPLOYEES 2022

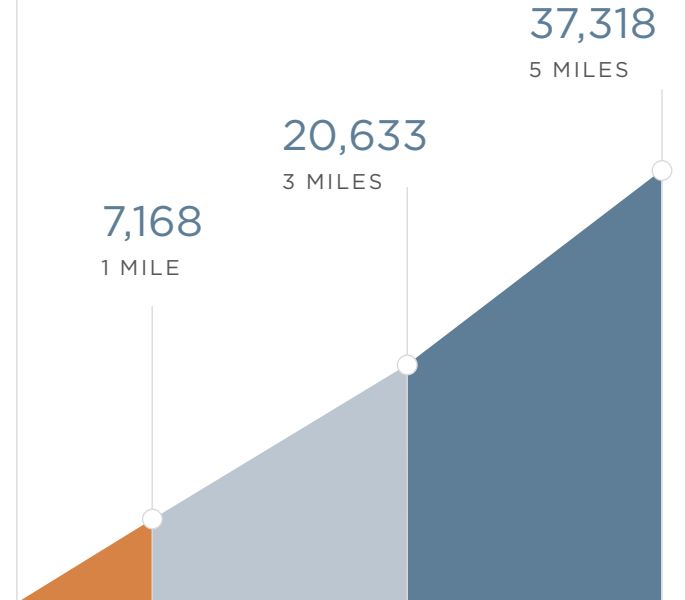



WILSONVILLE DISTRIBUTION CENTER

29899 SW BOONES FERRY RD, WILSONVILLE, OR

WILSONVILLEDC.COM

FOR LEASING INFORMATION, CONTACT

STEVEN KLEIN
503.221.2260
steven.klein@kidder.com

PETER STALICK
503.221.2272
peter.stalick@kidder.com

KIDDER.COM

OWNED BY

LBALogistics 

 **Kidder
Mathews**

This information supplied herein is from sources we deem reliable. It is provided without any representation, warranty, or guarantee, expressed or implied as to its accuracy. Prospective Buyer or Tenant should conduct an independent investigation and verification of all matters deemed to be material, including, but not limited to, statements of income and expenses. Consult your attorney, accountant, or other professional advisor.