

3777
SPINNAKER COURT
FREMONT, CALIFORNIA



±29,147 SF
AVAILABLE INDUSTRIAL SPACE

LBA Logistics  **CBRE**

PROPERTY HIGHLIGHTS

- ±29,147 SF Industrial Space
- 2,000 Amps @ 480/277V 3-Phase 4-Wire (Subject to Tenant Verification)
- 4 Dock High Doors
- 2 Grade Level Doors
- ±22' - ±24' Clear Height
- 180 Tons HVAC
- Fenced, Secured Rear Yard
- 2.85/1,000 Parking Ratio
- Available January 1, 2025

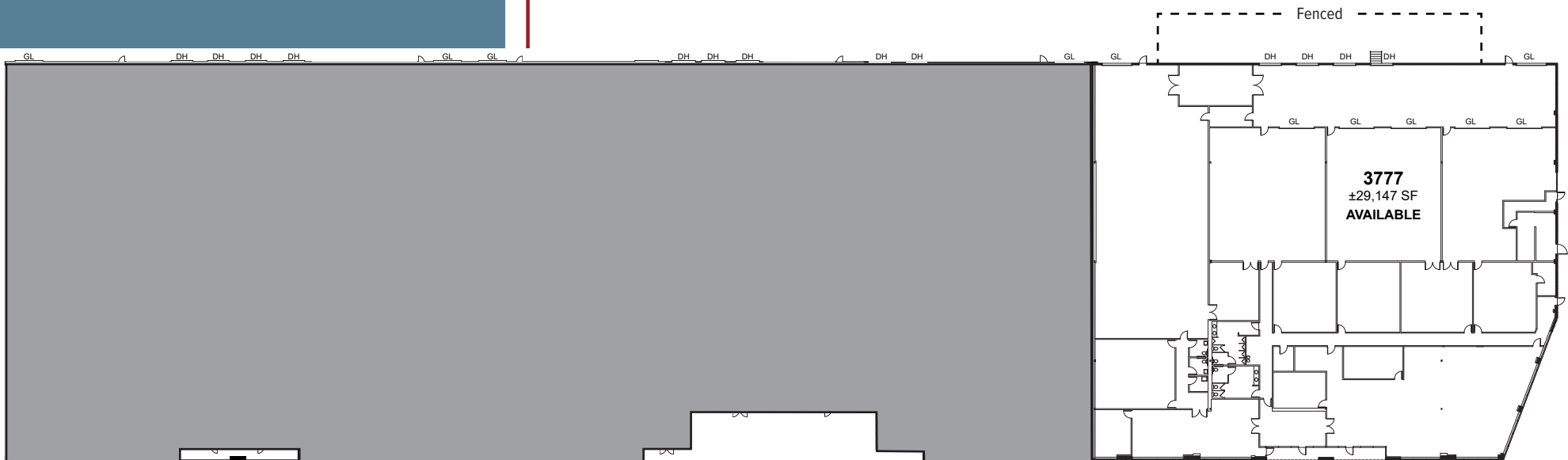

3777 SPINNAKER COURT FLOOR PLAN

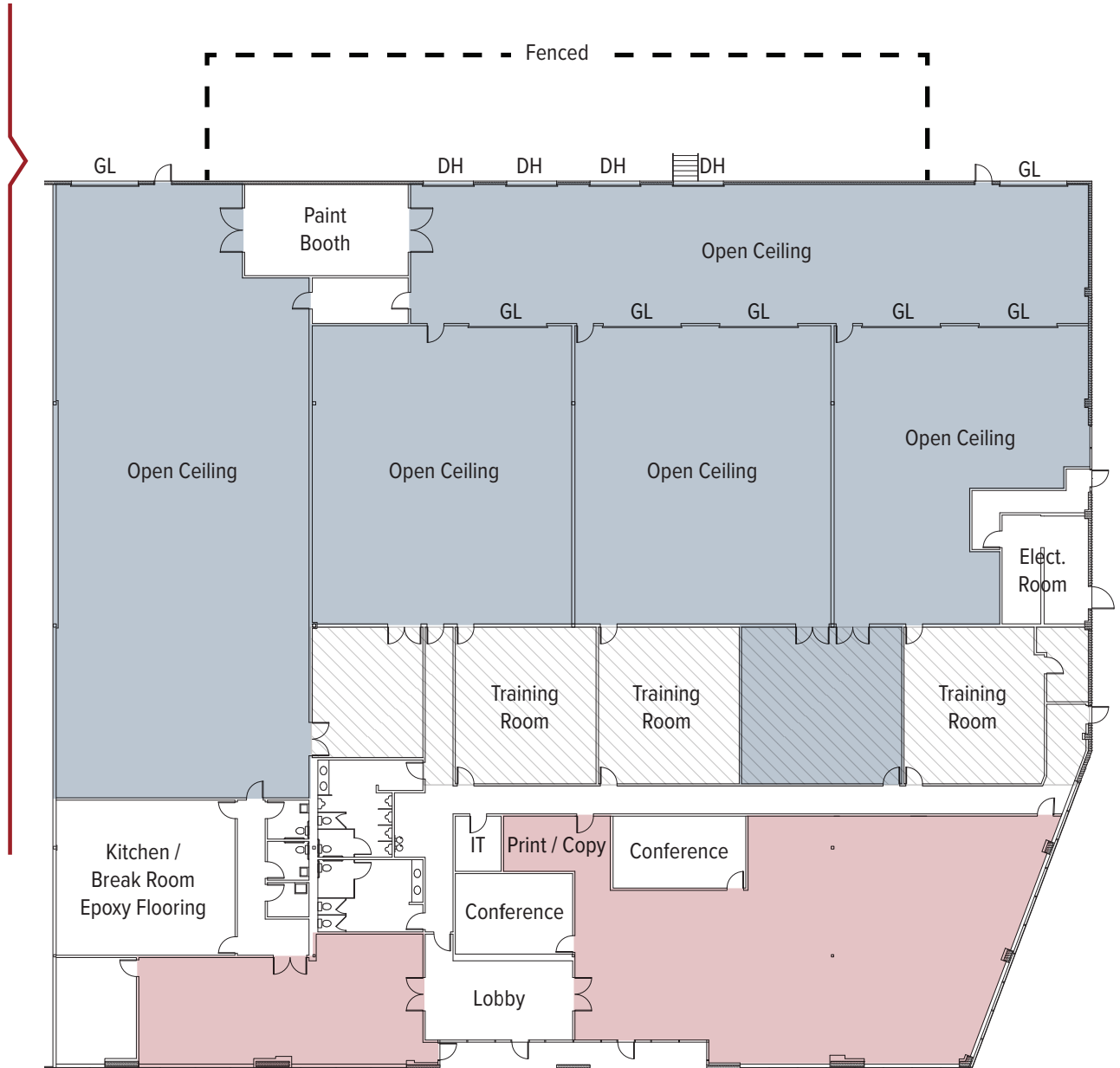

NOT TO SCALE

- 11' Drop Ceiling Office
- HVAC Epoxy Flooring
- 2nd Floor Steel Mezzanine Storage with Elevator Lift



NEARBY AMENITIES

MAP



HIGHWAY ACCESS

MAP

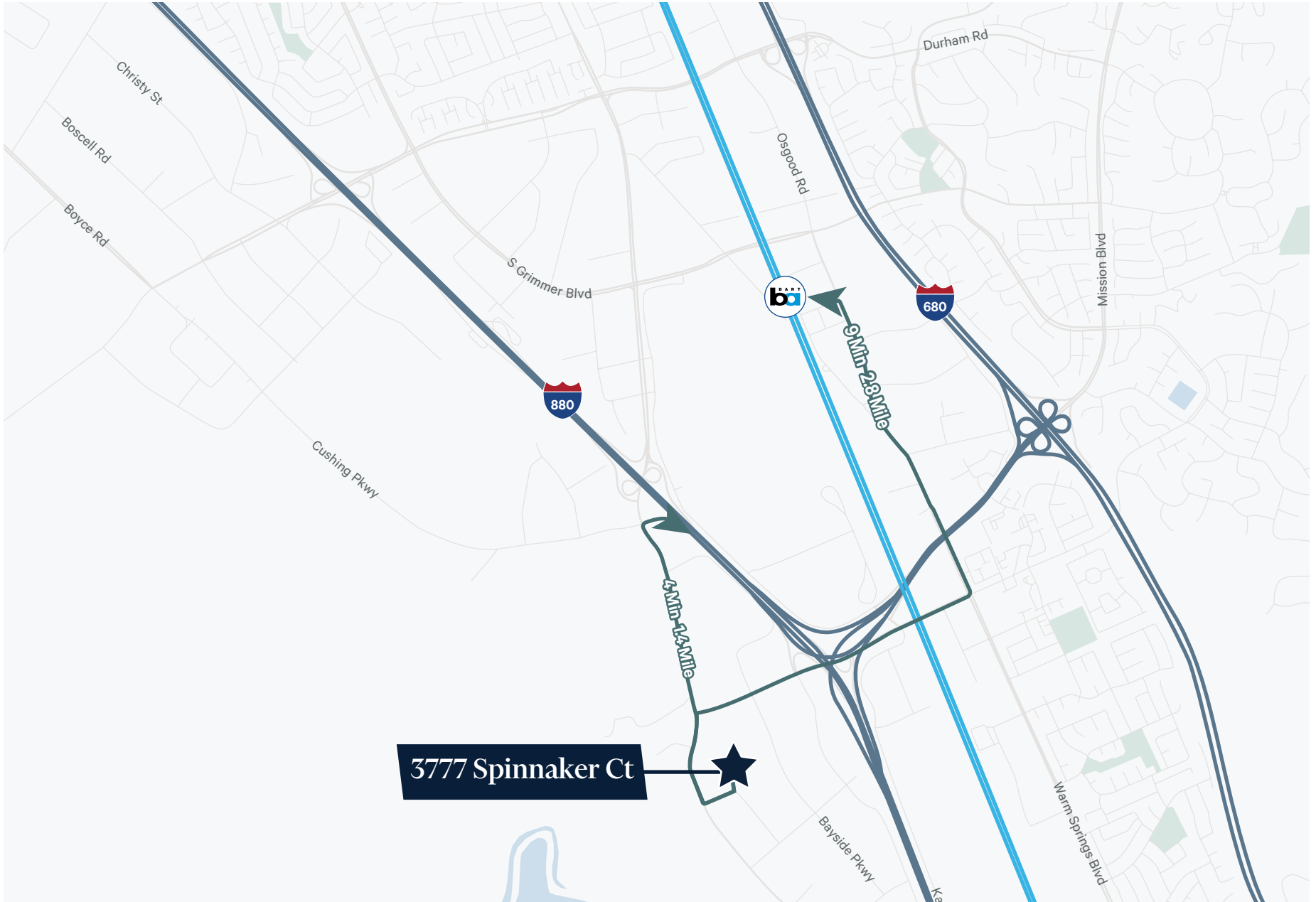



3777
SPINNAKER COURT
FREMONT, CALIFORNIA

CHIP SUTHERLAND

VICE CHAIRMAN
+1 408 453 7410
CHIP.SUTHERLAND@CBRE.COM
CA LIC. 01014633

SHERMAN CHAN

SENIOR VICE PRESIDENT
+1 408 453 7488
SHERMAN.CHAN@CBRE.COM
CA LIC. 01046769

JOEY MCSWEENEY

VICE PRESIDENT
+1 408 467 7553
JOEY.MCSWEENEY@CBRE.COM
CA LIC. 02033713

LBALogistics 
CBRE