

# Shoemaker Business Park

10618 Shoemaker Ave, Santa Fe Springs CA



Available  
**11,096 SF**

LBA Logistics 

**CBRE**



# PROPERTY HIGHLIGHTS

## HIGH IMAGE BUSINESS PARK & DESIRABLE MID-COUNTIES LOCATION



11,096 SF



1 Ground Level Door



3,775 SF Functional Office Space  
(625 of Mezzanine)



Fenced Yard (Shared)



24' Ceiling Clearance



Parking Ratio 2.00/1,000 SF



1 Dock Postion (Interior Truck Well)



Power 400 amps 277/480v (upon tenant verification)



Monument Signage Available



Convenient Access to the 5, 605, 91 and 105 Freeways



# SITE PLAN

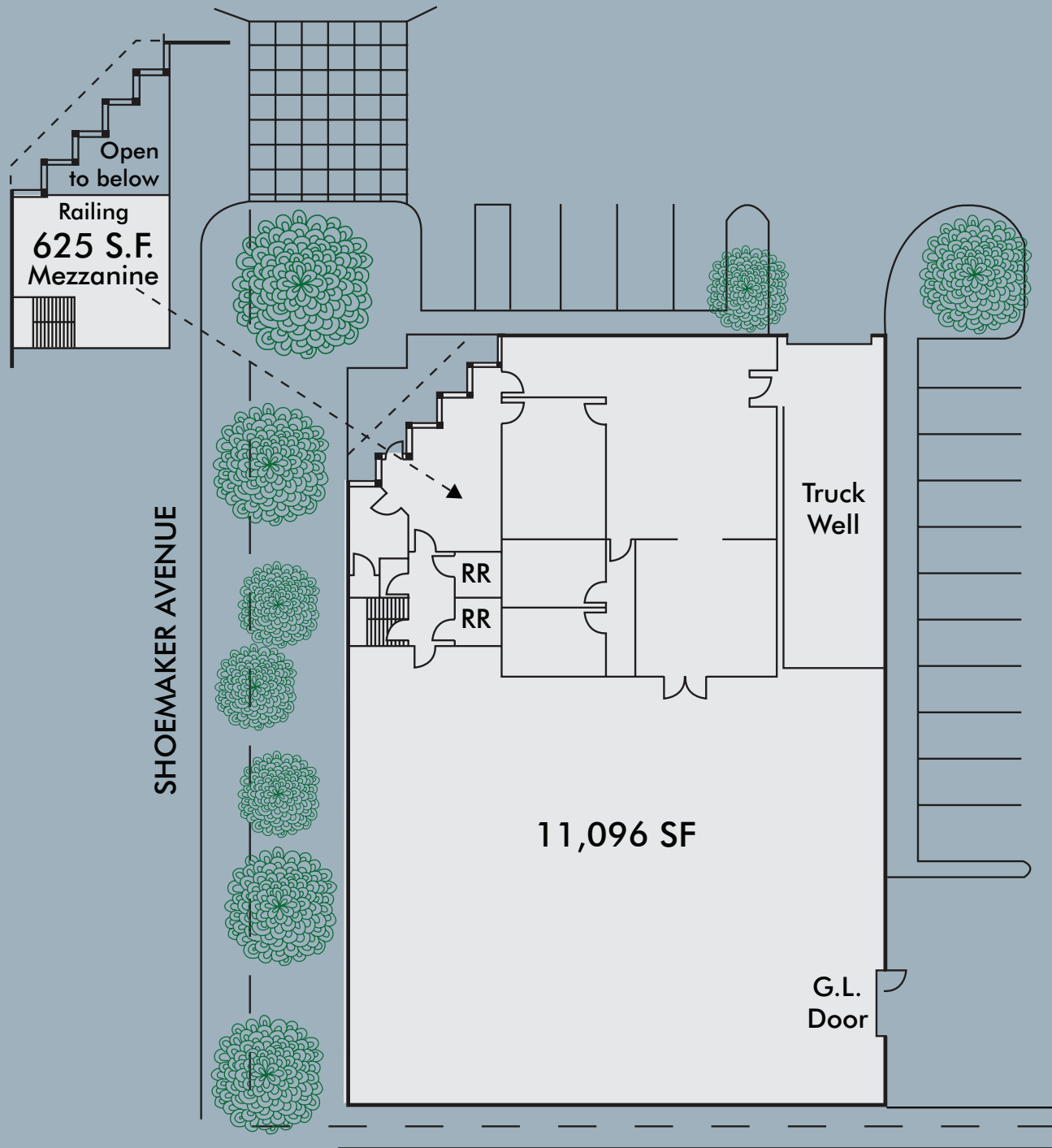

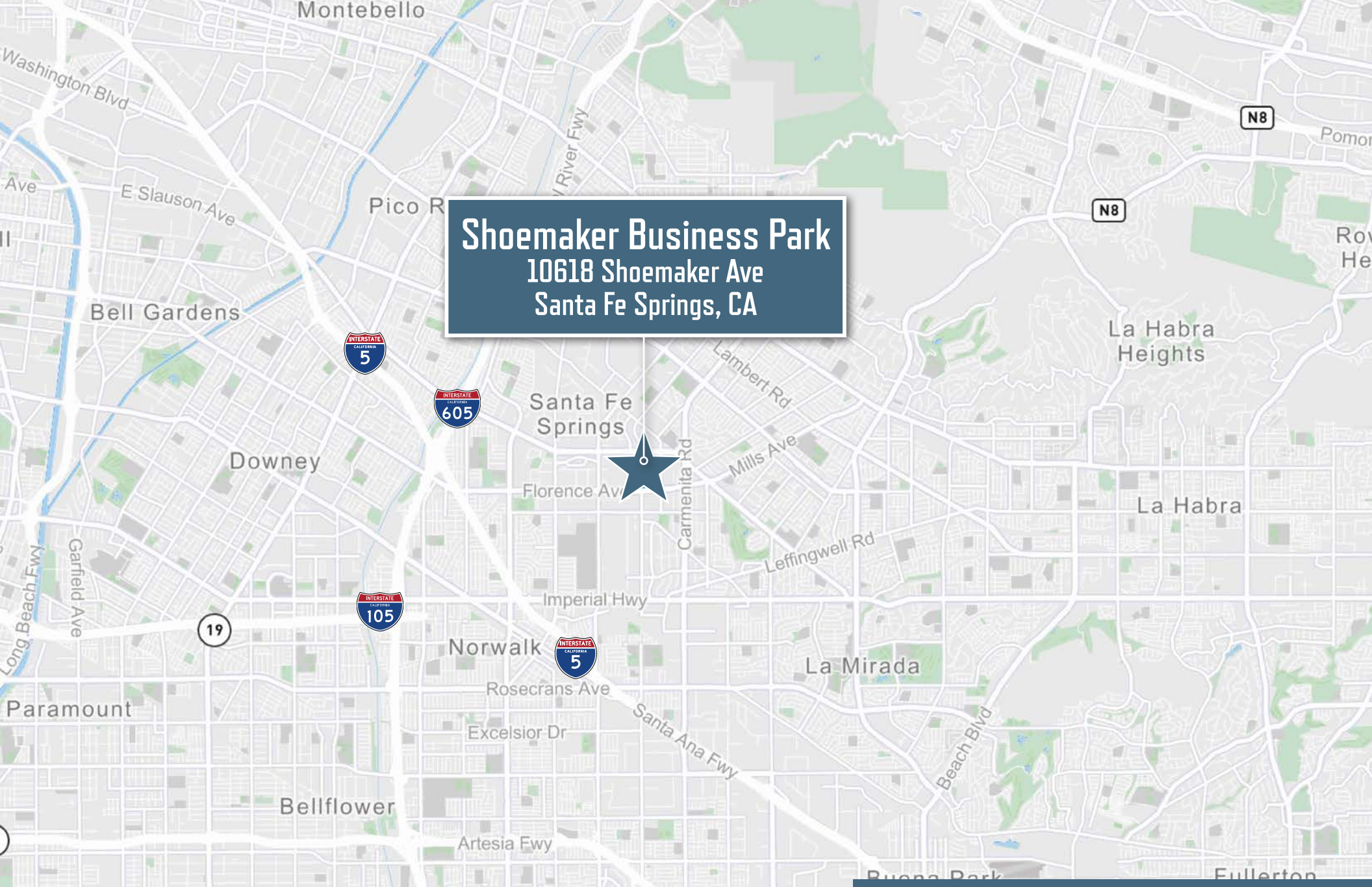

**Shoemaker Business Park**  
10618 Shoemaker Ave  
Santa Fe Springs, CA



**LOCATION MAP**





FOR MORE DETAILS, PLEASE CONTACT:

**JOHN BIVEN**

First Vice President

Lic. 00937552 | +1 562 968 1150

John.Biven@cbre.com

**CHRIS EHRLICH**

First Vice President

Lic. 01450093 | +1 562 968 1160

chris.ehrlich@cbre.com

**DALTON DOUTY**

Senior Associate

Lic. 02037282 | +1 714 345 9023

dalton.douty@cbre.com

**LBA**Logistics 

© 2023 CBRE, Inc. All rights reserved. This information has been obtained from sources believed reliable, but has not been verified for accuracy or completeness. You should conduct a careful, independent investigation of the property and verify all information. Any reliance on this information is solely at your own risk. CBRE and the CBRE logo are service marks of CBRE, Inc. All other marks displayed on this document are the property of their respective owners, and the use of such logos does not imply any affiliation with or endorsement of CBRE. Photos herein are the property of their respective owners. Use of these images without the express written consent of the owner is prohibited.

**CBRE**