

50,309 SF
Industrial Space For Lease

LBA Logistics 



3003 S. Pine St.

Tacoma, WA 98409

- 50,309 square feet (42,328 SF shell; 7,981 SF office)
- 2.27 acres (98,881 SF)
- Centrally located in the Nalley Valley with frontage on S Pine Street and Center Street
- Freestanding corporate image facility
- 9 dock high and 1 drive-in door
- 22' - 24' clear height
- Zoning: M-2 STGPD ST-M/IC, heavy industrial district



Dave Douglas, SIOR, CCIM
+1 253 203 1326
ddouglas@nai-psp.com

Arie Salomon, SIOR, CCIM
+1 425 586 5636
asalomon@nai-psp.com

Aaron Rosen
+1 253 203 1319
arosen@nai-psp.com

Kyle Schipper
+1 253 203 1320
kschipper@nai-psp.com

50,309 SF

Industrial Space For Lease

LBA Logistics 



NAI Puget Sound Properties

10900 NE 8th Street, Suite 1500
Bellevue, WA 98004
+1 425 586 5600
nai-pp.com

THE INFORMATION CONTAINED HEREIN HAS BEEN GIVEN TO US BY THE OWNER OF THE PROPERTY OR OTHER SOURCES WE DEEM RELIABLE. WE HAVE NO REASON TO DOUBT ITS ACCURACY, BUT WE DO NOT GUARANTEE IT. ALL INFORMATION SHOULD BE VERIFIED PRIOR TO PURCHASE OR LEASE.

50,309 SF

Industrial Space For Lease



First Floor

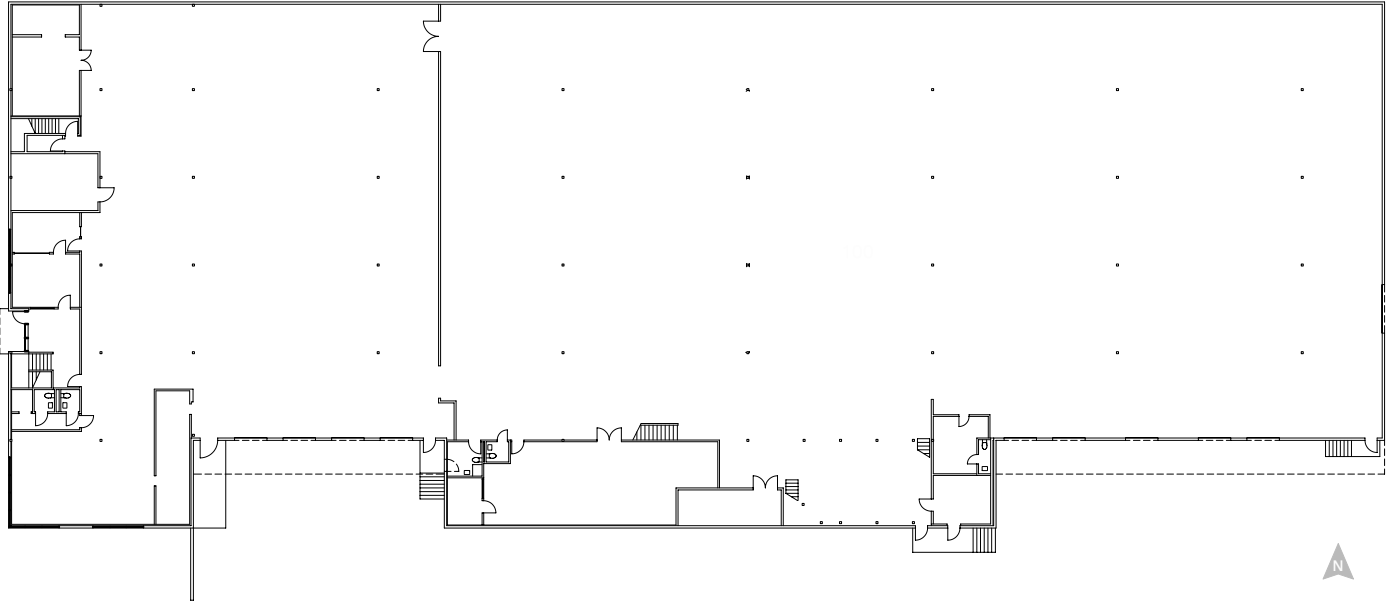

Second Floor

