

# ANDOVER PARK EAST

770 ANDOVER PARK EAST • TUKWILA, WA

18,874 SF  
AVAILABLE

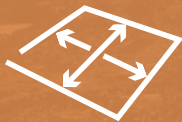

18,874 SF total available  
Restrooms and breakroom built out



1 dock-high door



Ample parking



Great access to I-5 and SR-167



Exposure to Andover Park East



Available 4/1/2025

**MATT MCGREGOR**  
Vice Chair  
+1 206 624 7401  
matt.mcgregor@colliers.com

**BILL CONDON**  
Vice Chair  
+1 206 235 9732  
bill.condon@colliers.com

**JACK MURPHY**  
Senior Associate  
+1 206 287 0210  
jack.murphy@colliers.com

**LBA**Logistics   
**Colliers**

# Site Plan

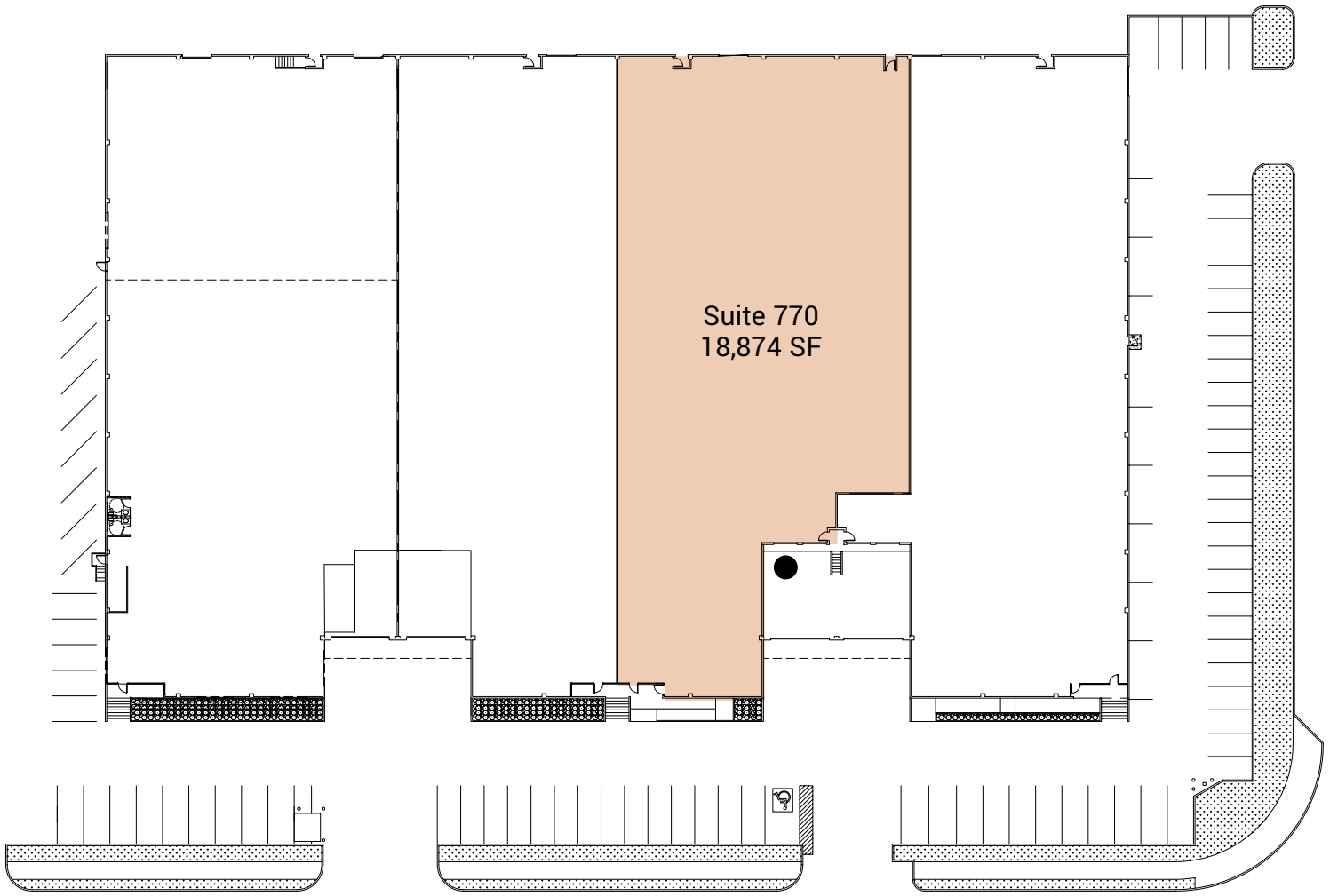

● Dock-high Door



**ANDOVER**  
**PARK EAST**  
 770 ANDOVER PARK EAST • TUKWILA, WA

**MATT MCGREGOR**  
 Vice Chair  
 +1 206 624 7401  
[matt.mcgregor@colliers.com](mailto:matt.mcgregor@colliers.com)

**BILL CONDON**  
 Vice Chair  
 +1 206 235 9732  
[bill.condon@colliers.com](mailto:bill.condon@colliers.com)

**JACK MURPHY**  
 Senior Associate  
 +1 206 287 0210  
[jack.murphy@colliers.com](mailto:jack.murphy@colliers.com)

LBA Logistics  Colliers

# Location



 **ANDOVER**  
PARK EAST  
770 ANDOVER PARK EAST • TUKWILA, WA

**MATT MCGREGOR**  
Vice Chair  
+1 206 624 7401  
[matt.mcgregor@colliers.com](mailto:matt.mcgregor@colliers.com)

**BILL CONDON**  
Vice Chair  
+1 206 235 9732  
[bill.condon@colliers.com](mailto:bill.condon@colliers.com)

**JACK MURPHY**  
Senior Associate  
+1 206 287 0210  
[jack.murphy@colliers.com](mailto:jack.murphy@colliers.com)

LBA Logistics  Colliers