

44931 INDUSTRIAL DRIVE

FREMONT, CALIFORNIA



WAREHOUSE/LIGHT ASSEMBLY FOR LEASE ±14,026 SF SF

PROPERTY FEATURES AND FACTS

- State-of-the-Art, Multi Tenant Building
- Warehouse/Light Assembly Space
- 25'-27' Clear Height
- Concrete Truck Aprons
- ESFR Fire Sprinklers
- 6" Steel Reinforced Concrete Floor Slab
- Parking: 2.6/1,000
- General Industrial Zoning
- Great I-880 and I-680 Access
- Strategically Located in Fremont, in the heart of the Bay Area/Silicon Valley Industrial Market

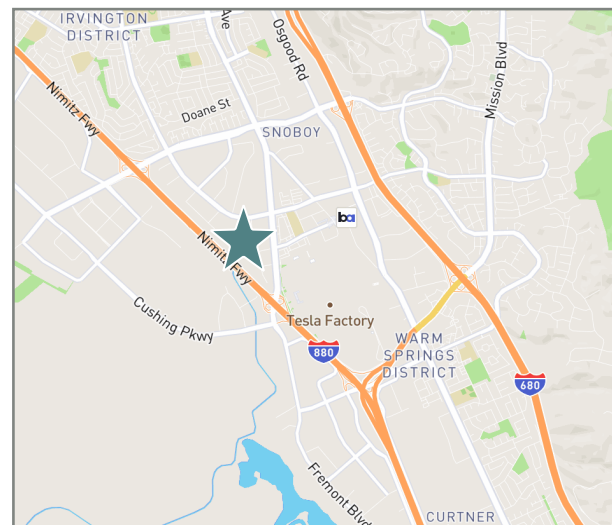

**PROPERTY OWNED
& MANAGED BY**



FOR MORE INFORMATION PLEASE CONTACT

Rob Shannon
Executive Vice President
Lic. 00857593
+1 408 453 7486
rob.shannon@cbre.com



44931 INDUSTRIAL DRIVE

FREMONT, CALIFORNIA

SITE PLAN

44931 INDUSTRIAL DRIVE

±14,026 SF

±4,102 SF OFFICE

2 DOCK HIGH DOORS

1 DOCK HIGH KNOCK OUT DOOR

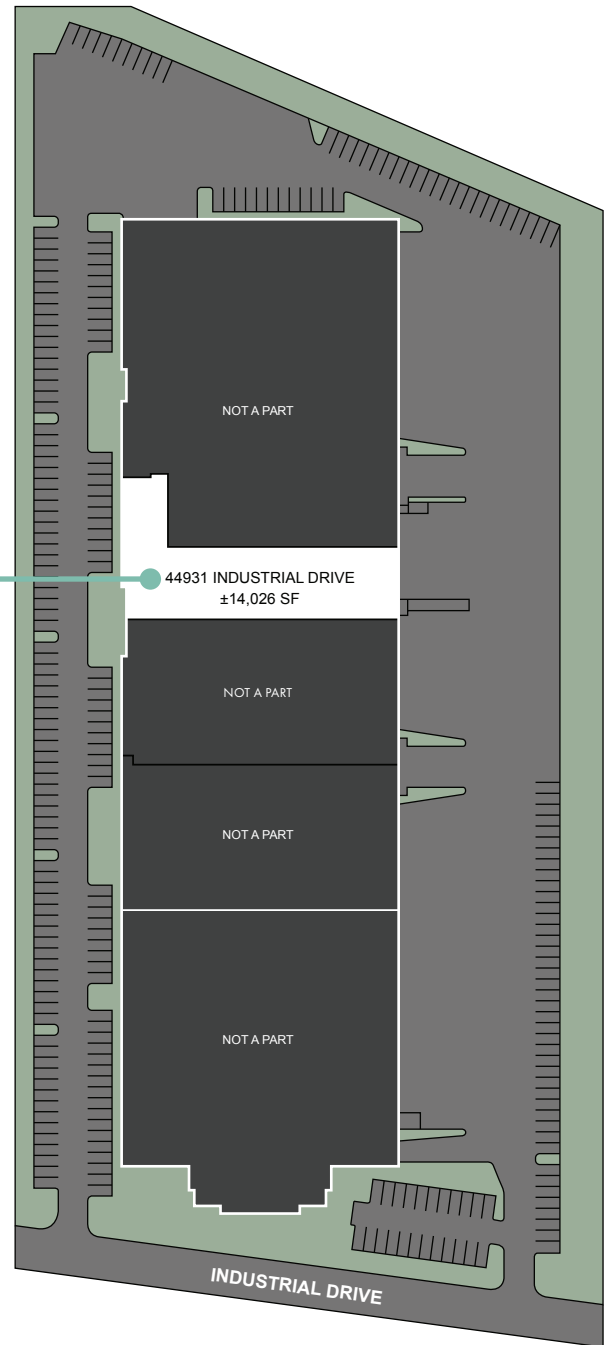

NOT TO SCALE

44931 INDUSTRIAL DRIVE

FREMONT, CALIFORNIA

44931 INDUSTRIAL DRIVE

- **±14,026 SF**
- ±4,102 SF OFFICE
- 2 DOCK HIGH DOORS
- 1 DOCK HIGH KNOCK OUT DOOR
- 200 AMPS @ 480/277 V, 3PHASE POWER (SUBJECT TO TENANT VERIFICATION)
- 26' MINIMUM TRUSS HEIGHT
- 27' MINIMUM COLUMN HEIGHT

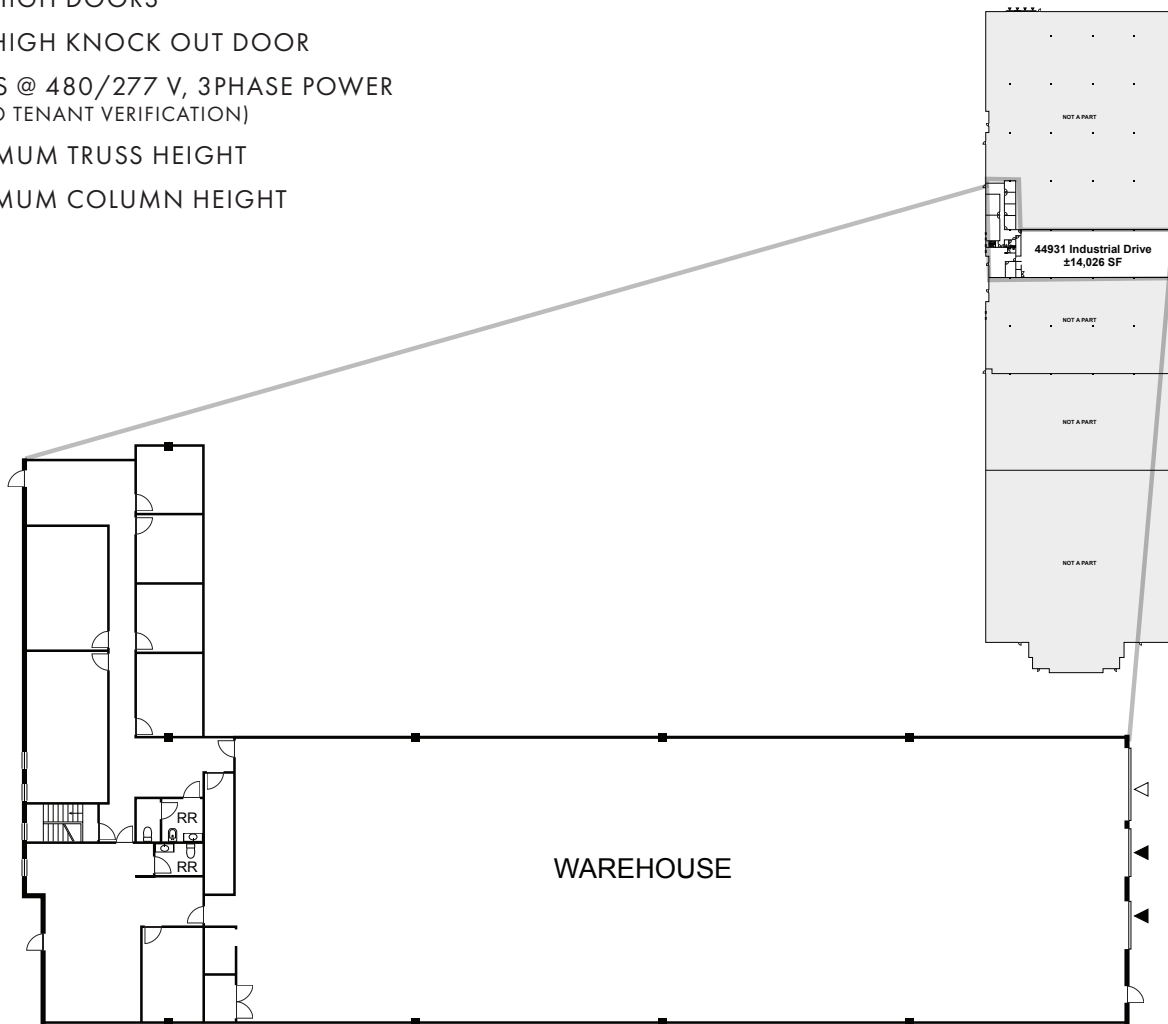

NOT TO SCALE

◀ Dock High Door

◁ Dock High Knockout

44931 INDUSTRIAL DRIVE

FREMONT, CALIFORNIA

REGIONAL DRIVE TIME MAP

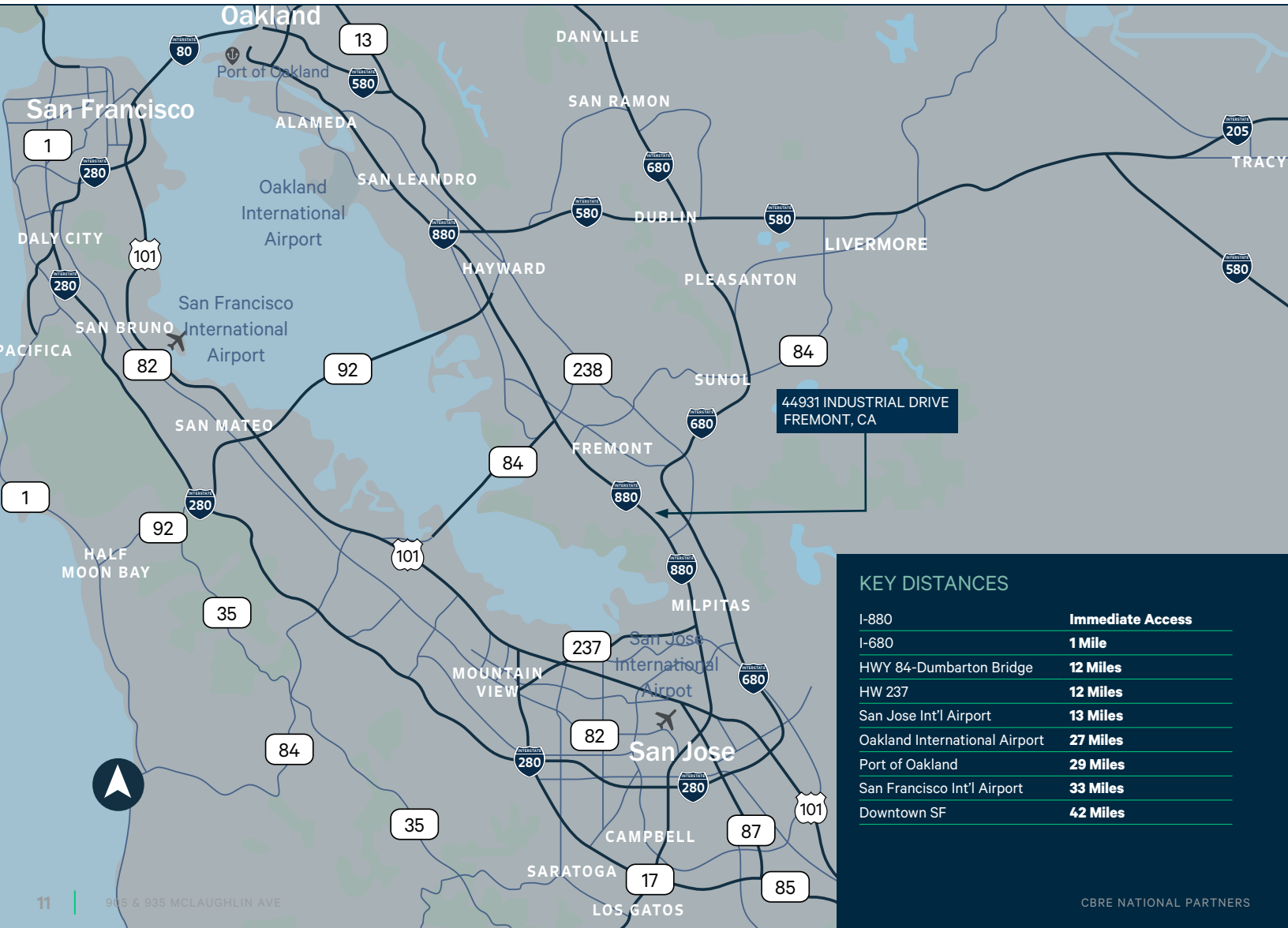

44931 INDUSTRIAL DRIVE

FREMONT, CALIFORNIA



NEARBY AMENITIES

**44931 INDUSTRIAL DRIVE
FREMONT, CA**

Pacific Commons Shopping Center

- DICK'S
- Target
- Lowe's
- OLD NAVY
- BLAZE PIZZA
- verizon
- HomeGoods
- COSTCO
- ULTA
- TJ-maxx
- Total Wine
- DSW
- SUBWAY
- Knispys Home
- rack
- FIVE GUYS
- Jamba
- Panera Bread
- IN-N-OUT BURGER
- Habit
- citi
- COLD STONE
- SportClips

Skyway Plaza

- Walmart
- CEFCU
- AT&T
- in the box
- Great Clips
- DOLLAR TREE

- Cart's Jr.
- Jack in the Box
- Pink Panthers
- Chaat House
- CVS pharmacy
- Denny's

- ROUND TABLE PIZZA
- HSBC
- SAFeway
- USPS.COM
- TACO BELL
- KFC
- BANK OF AMERICA
- FedEx

Mission Square

- citi
- OSAKA
- WELLS FARGO
- Happy Lemon

© 2026 CBRE, Inc. All rights reserved. This information has been obtained from sources believed reliable, but has not been verified for accuracy or completeness. You should conduct a careful, independent investigation of the property and verify all information. Any reliance on this information is solely at your own risk. CBRE and the CBRE logo are service marks of CBRE, Inc. All other marks displayed on this document are the property of their respective owners, and the use of such logos does not imply any affiliation with or endorsement of CBRE. Photos herein are the property of their respective owners. Use of these images without the express written consent of the owner is prohibited. PMStudio_March2026

PROPERTY OWNED & MANAGED BY



FOR MORE INFORMATION PLEASE CONTACT

Rob Shannon
Executive Vice President
Lic. 00857593
+1 408 453 7486
rob.shannon@cbre.com

