

3902 B STREET NW

AUBURN, WASHINGTON



CBRE

LBALogistics 

 **FOR LEASE**

+/- 30,000 SF INDUSTRIAL SPACE FOR LEASE



SITE PLAN

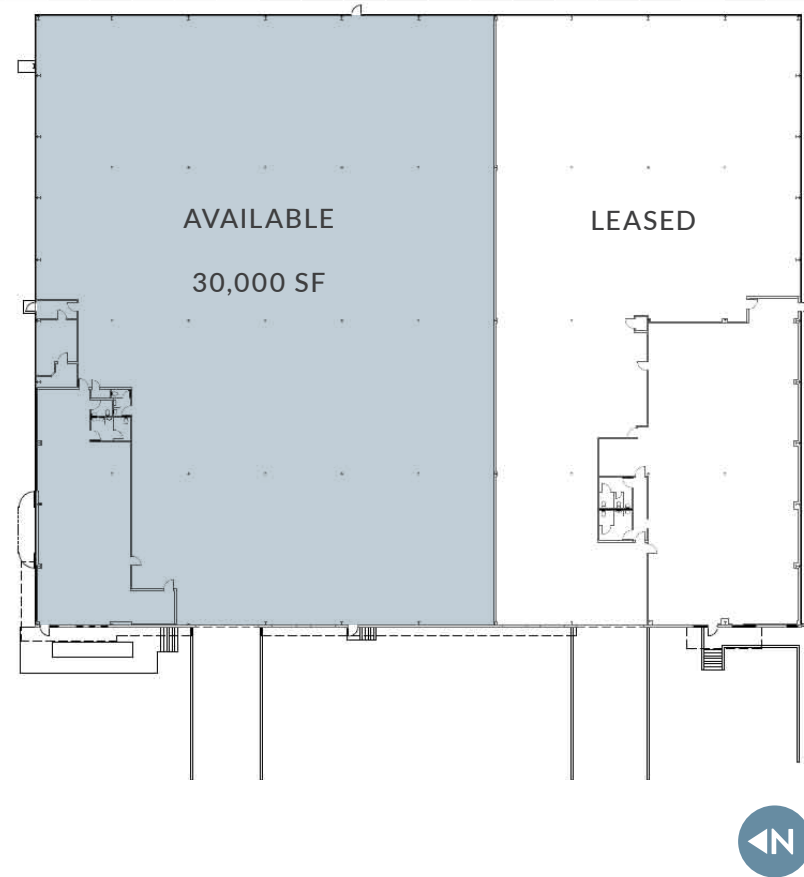

PROPERTY FEATURES



30,000 SF AVAILABLE IN
STAND ALONE BUILDING



2,700 SF OFFICE



END CAP SPACE



EASY ACCESS
TO HWY 167



2 DOCKS
1 OVERSIZE RAMP DOOR



24' CLEAR HEIGHT



AVAILABLE
MARCH 1, 2022

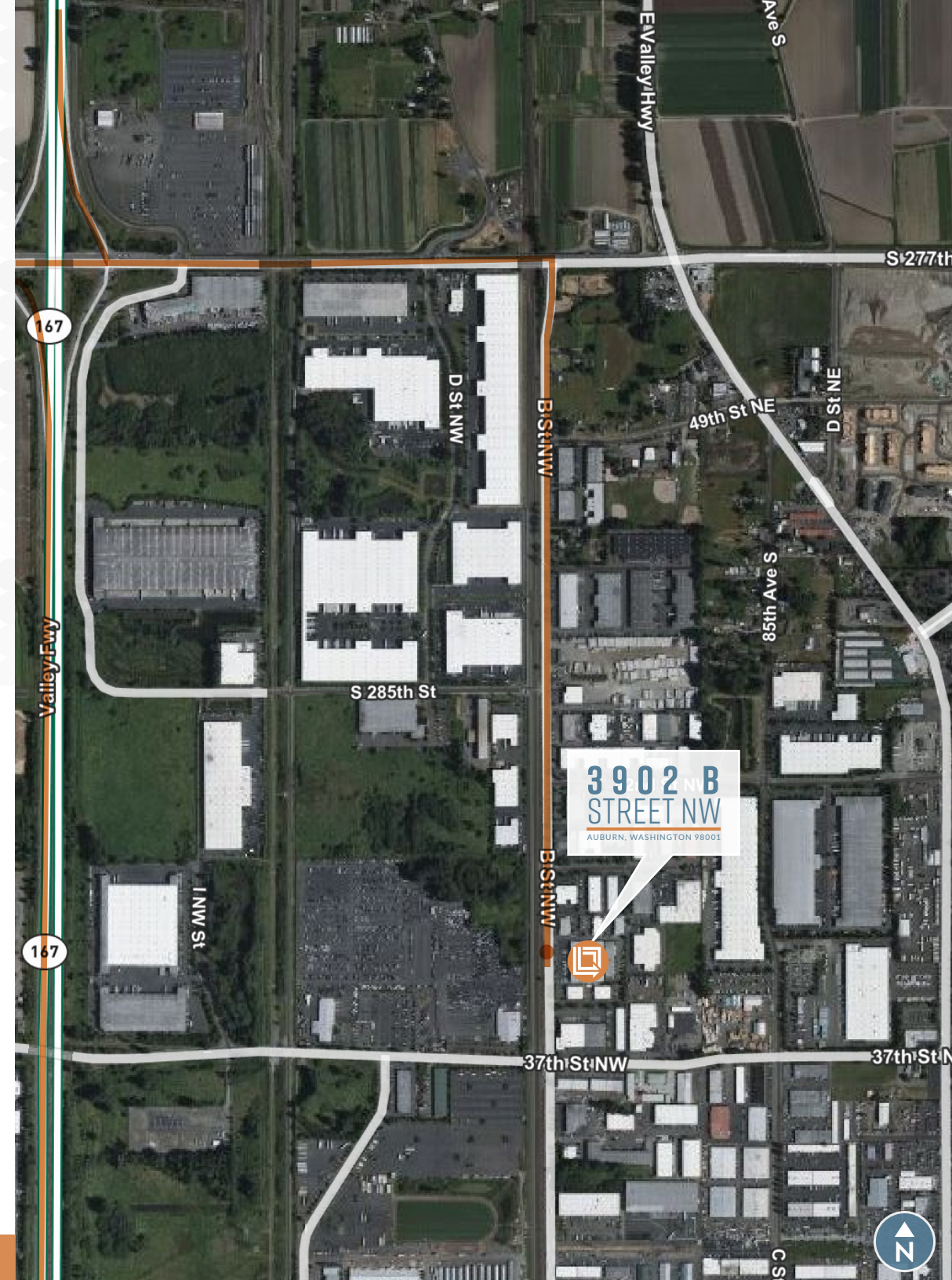

FOR INFORMATION, CONTACT

ZAC SNEDEKER

First Vice President

+1 206 442 2709

zac.snedeker@cbre.com

ANDREW STARK

Senior Vice President

+1 206 442 2746

andrew.stark@cbre.com

ANDREW HITCHCOCK

Executive Vice President

+1 206 442 2719

andrew.hitchcock@cbre.com

CBRE, INC. | 1420 Fifth Ave | Suite 1700 | Seattle, WA

© 2021 CBRE, Inc. All rights reserved. This information has been obtained from sources believed reliable, but has not been verified for accuracy or completeness. You should conduct a careful, independent investigation of the property and verify all information. Any reliance on this information is solely at your own risk. CBRE and the CBRE logo are service marks of CBRE, Inc. All other marks displayed on this document are the property of their respective owners, and the use of such logos does not imply any affiliation with or endorsement of CBRE. Photos herein are the property of their respective owners. Use of these images without the express written consent of the owner is prohibited. KA112321

CBRE

LBALogistics

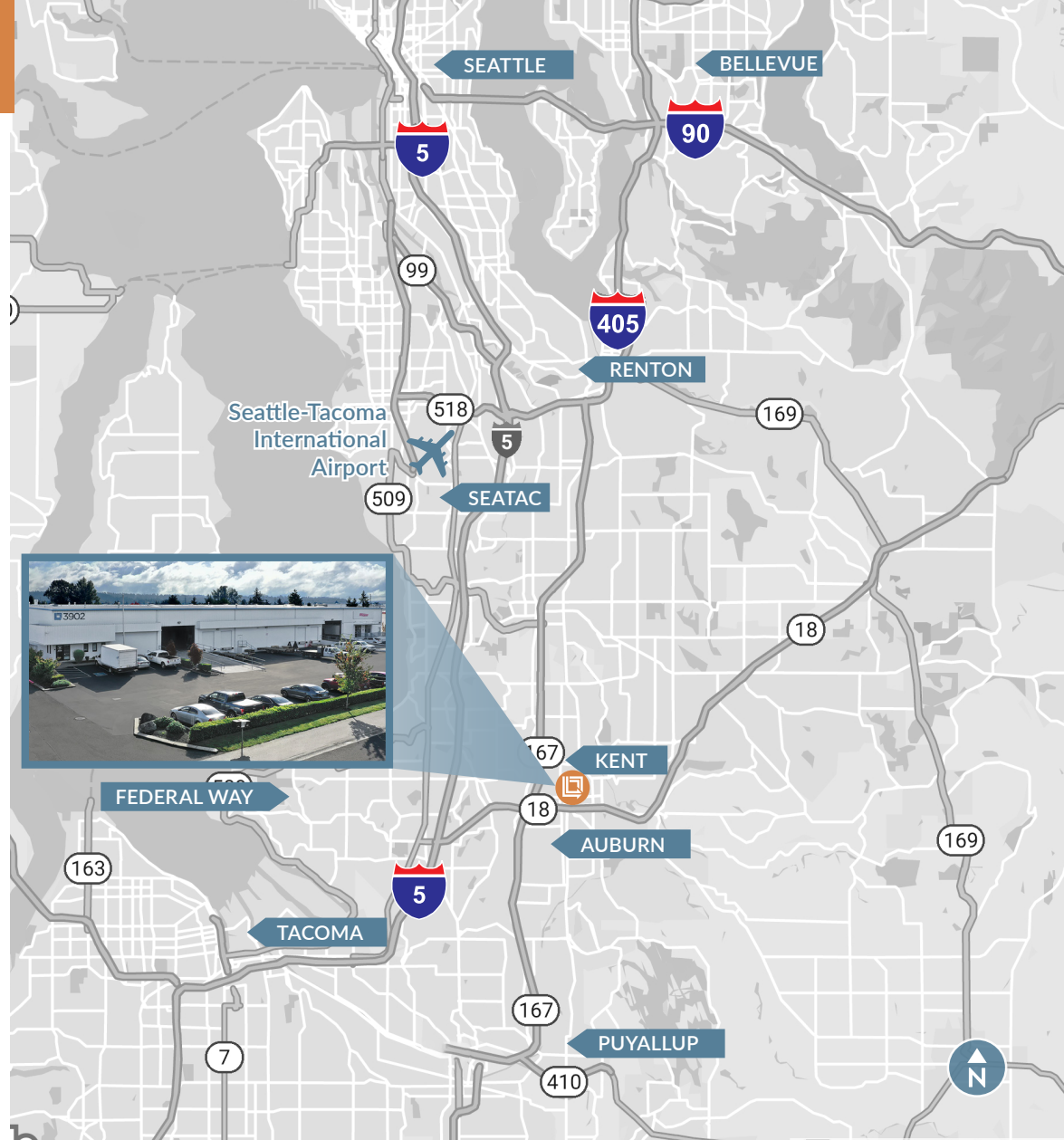

DISTANCES TO/FROM
3902 B STREET NW
AUBURN, WA



**12 MILES TO SEA-TAC
INTERNATIONAL
AIRPORT**



**23 MILES TO
SEATTLE**



**16 MILES TO
TACOMA**



**22 MILES TO
BELLEVUE**