

3550
ODESSA WAY

FOR LEASE

94,659 SF

3550 Odessa Way
Aurora, Colorado 80011



Multistory office space available | Fully fenced outside storage area

INDUSTRIAL SPACE AVAILABLE FOR LEASE

94,659 SF AVAILABLE

FEATURES:

- TOTAL OFFICE SIZE 8,371 SF**
1ST FLOOR: APPROX. 4,125 SF
2ND FLOOR: APPROX. 4,246 SF
- FENCED YARD**
APPROX. 10,693 SF
- 1 RAMP DRIVE IN**
- 9 DOCK DOORS WITH LEVELERS**
- 3 RECESSED DOCKS**
- CLEAR HEIGHT 23'**
- ASKING RATE \$6.75/SF NNN**
- BUILDING DEPTH 240'**
- COLUMN SPACING 40'W X 30'D**
- ESFR SPRINKLER SYSTEM**
- PARKING RATIO 1.1/1,000**
- POWER 277 - 480V**



LOCATION

Majestic Commercenter is a high quality 1,000-acre industrial park. Well located at the northeast corner of I-70 and Tower Road, providing quick access to Denver International Airport, I-70, I-225 and E-470.

3550 Odessa, Suite A at 94,659 SF is available now!

LOCATION HIGHLIGHTS:

15 min drive
to Denver International Airport (DEN)

20 min drive
to Downtown Denver

Excellent access
to I-70, E-470 and I-225

Close proximity
to Tower Road amenities

Opportunity zoned
tax incentives through the City of Aurora premier distribution submarket

Located
within Denver's premier distribution submarket

New RTD
Commuter Rail from Downtown to Denver International Airport

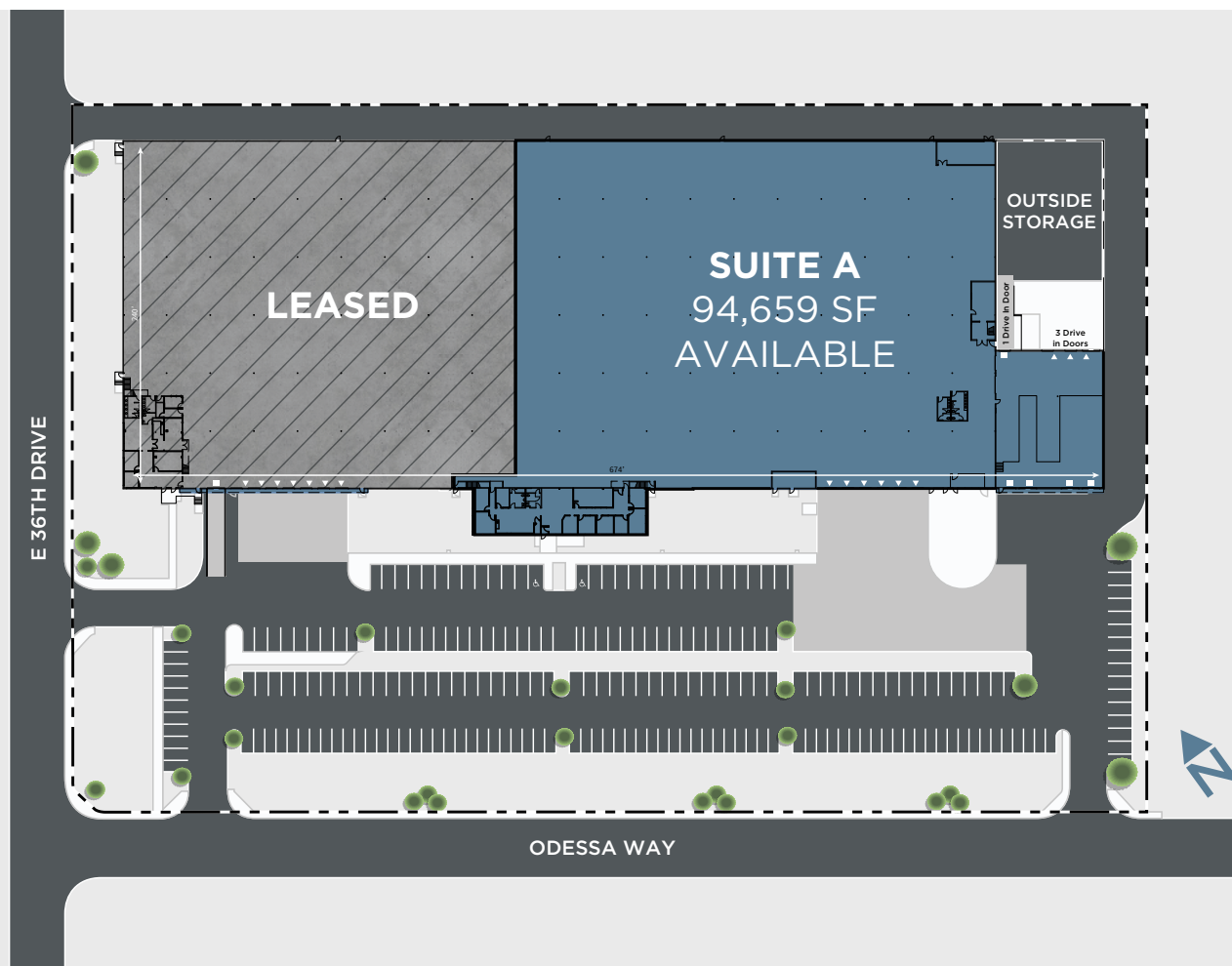



3550
ODESSA WAY

For leasing information, please contact:

MITCH ZATZ
mitch.zatz@jll.com
+1 303 217 7972

JASON WHITE
jason.white@jll.com
+1 303 390 5200

CARMON HICKS, SIOR
carmon.hicks@jll.com
+1 303 217 7975

LBA Logistics

JLL®

Although information has been obtained from sources deemed reliable, neither Owner nor JLL makes any guarantees, warranties or representations, express or implied, as to the completeness or accuracy as to the information contained herein. Any projections, opinions, assumptions or estimates used are for example only. There may be differences between projected and actual results, and those differences may be material. The Property may be withdrawn without notice. Neither Owner nor JLL accepts any liability for any loss or damage suffered by any party resulting from reliance on this information. If the recipient of this information has signed a confidentiality agreement regarding this matter, this information is subject to the terms of that agreement. ©2022. Jones Lang LaSalle IP, Inc. All rights reserved.**The outbreak of the COVID-19 virus (novel coronavirus) since the end of January 2020 has resulted in market uncertainty and volatility. While the economic impact of a contagion disease generally arises from the uncertainty and loss of consumer confidence, its impact on real estate values is unknown at this stage.