

FOR LEASE | ±53,416 SF



LBA Logistics

STIMSON INDUSTRIAL PARK

16057 E VALLEY BOULEVARD, CITY OF INDUSTRY, CA 91744



Building Amenities:

- › Central City of Industry Location
- › 20' Minimum Ceiling Clearance
- › ±4,059 SF Office Space
- › Secured Business Park Environment
- › 3 Dock High Positions
- › 4 Ground Level Doors
- › Excellent Access to 60, 605 and 10 Freeways

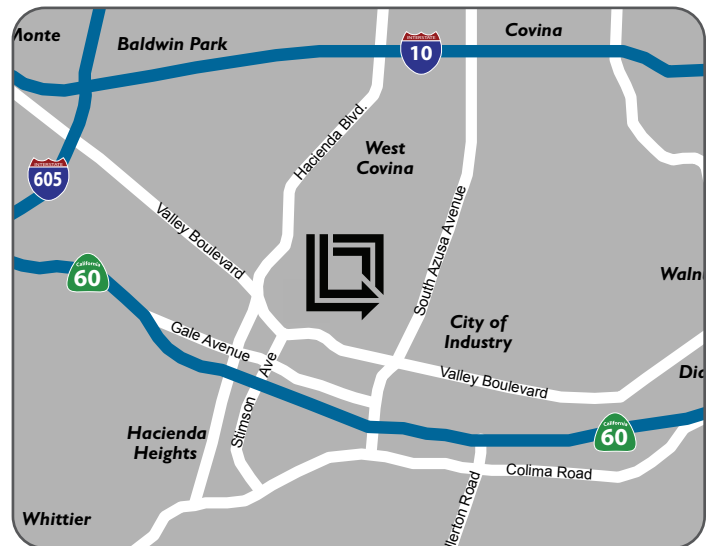

STEVEN J. BELLITTI
LICENSE NO. 01048797
909 612 2617
steve.bellitti@colliers.com

TONY T. PHU
LICENSE NO. 01129178
626 283 4560
tony.phu@colliers.com

COLLIERS INTERNATIONAL
17800 Castleton Street, Suite 495
City of Industry, CA 91748
www.colliers.com



FOR LEASE | ±53,416 SF



STIMSON INDUSTRIAL PARK

16057 E VALLEY BOULEVARD, CITY OF INDUSTRY, CA 91744

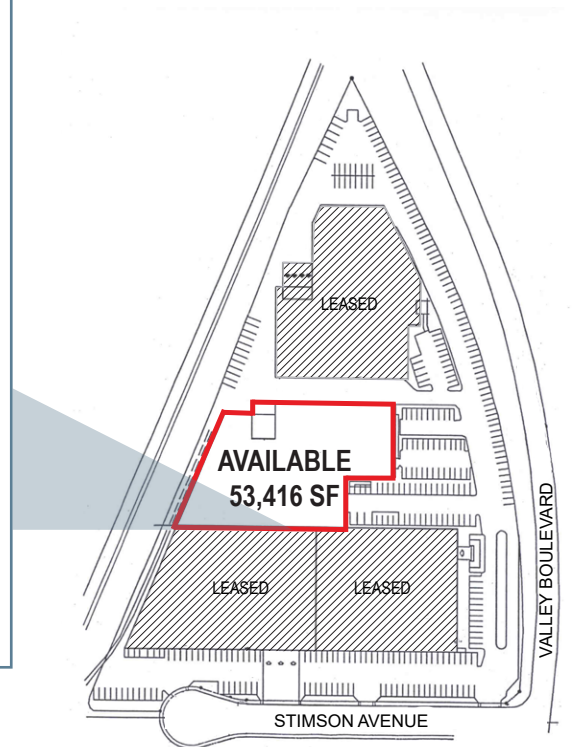
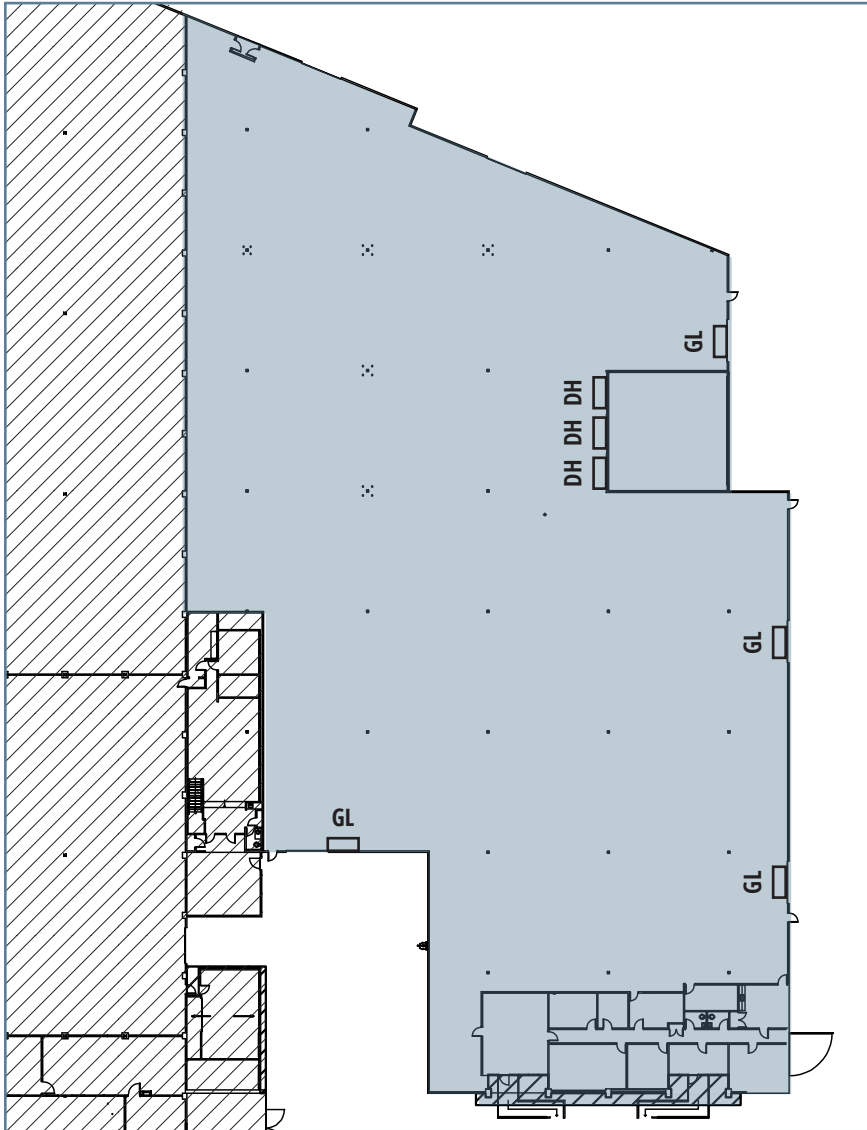

STEVEN J. BELLITTI
LICENSE NO. 01048797
909 612 2617
steve.bellitti@colliers.com

TONY T. PHU
LICENSE NO. 01129178
626 283 4560
tony.phu@colliers.com

COLLIERS INTERNATIONAL
17800 Castleton Street, Suite 495
City of Industry, CA 91748
www.colliers.com



This document has been prepared by Colliers International for advertising and general information only. Colliers International makes no guarantees, representations or warranties of any kind, expressed or implied, regarding the information including, but not limited to, warranties of content, accuracy and reliability. Any interested party should undertake their own inquiries as to the accuracy of the information. Colliers International excludes unequivocally all inferred or implied terms, conditions and warranties arising out of this document and excludes all liability for loss and damages arising there from. This publication is the copyrighted property of Colliers International and/or its licensor(s). ©2021. All rights reserved.