

For Lease

CBRE

Dupont Industrial Center

±18,833

SF AVAILABLE

1555 Dupont Ave, Suite A, Ontario, CA 91761



Building Features

- + ±17,821 SF Industrial Building
- + ±1,012 SF of office space
- + 24' clear height
- + 0.45 GPM/3,000 SF sprinkler system
- + 2 dock high doors
- + 1 grade level door
- + 48' x 48' typical bay spacing
- + 188' reciprocal trucking court and staging area
- + Secured, concrete truck court
- + Located within a foreign trade zone
- + Part of California Commerce Center

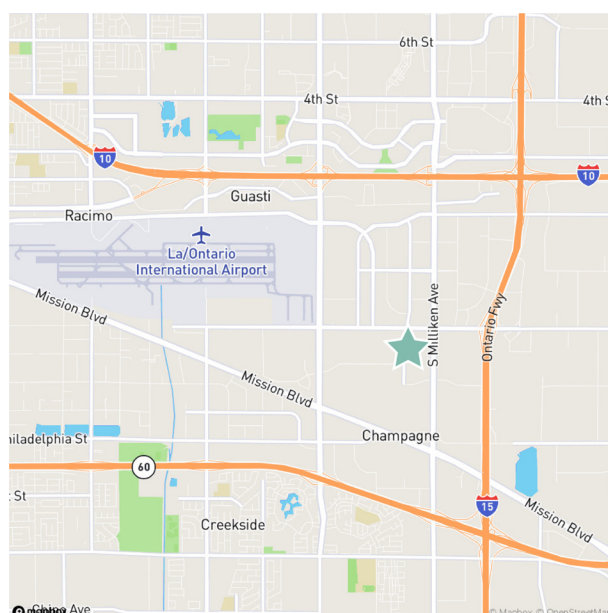

Contact Us

Len Santoro

+1 909 418 2158

len.santoro@cbre.com

Lic. 00758706

Wes Jones

+1 909 418 2070

wes.jones@cbre.com

Lic. 01783489

Ryan Athens

+1 909 418 2021

ryan.athens@cbre.com

Lic. 01387750

±18,833 SF AVAILABLE

1555 DUPONT AVE, SUITE A, ONTARIO, CA 91761

For Lease

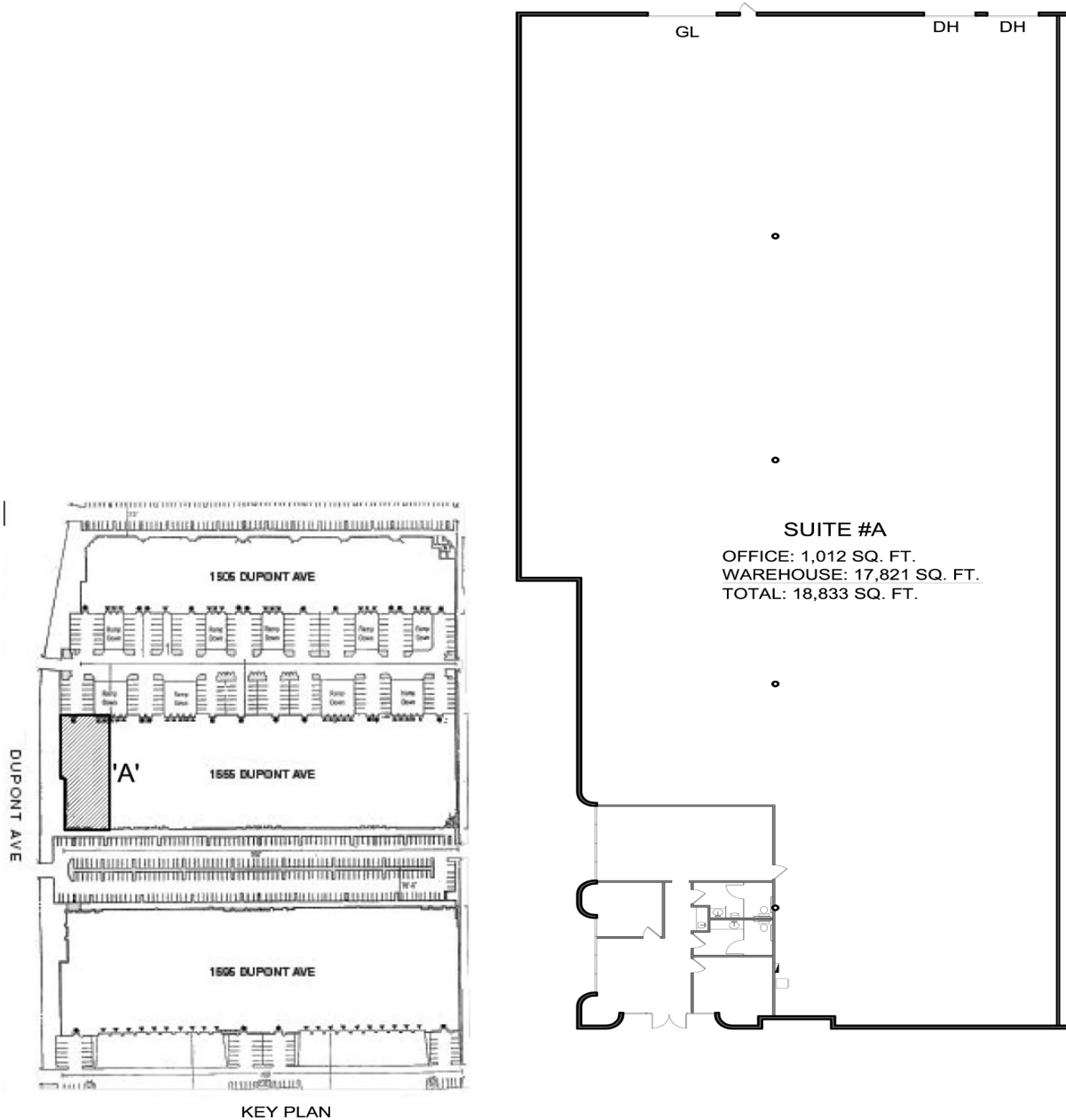

Contact Us

Len Santoro

+1 909 418 2158

len.santoro@cbre.com

Lic. 00758706

Wes Jones

+1 909 418 2070

wes.jones@cbre.com

Lic. 01783489

Ryan Athens

+1 909 418 2021

ryan.athens@cbre.com

Lic. 01387750

© 2023 CBRE, Inc. All rights reserved. This information has been obtained from sources believed reliable, but has not been verified for accuracy or completeness. You should conduct a careful, independent investigation of the property and verify all information. Any reliance on this information is solely at your own risk. CBRE and the CBRE logo are service marks of CBRE, Inc. All other marks displayed on this document are the property of their respective owners, and the use of such logos does not imply any affiliation with or endorsement of CBRE. Photos herein are the property of their respective owners. Use of these images without the express written consent of the owner is prohibited.

For Lease

CBRE

Dupont Industrial Center

±6,960
SF AVAILABLE

1505 Dupont Ave, Suite F | Ontario, CA 91761



Building Features

- + ±6,960 SF Industrial Building
- + ±1,130 SF of office space
- + 20' minimum clear height
- + 0.33 GPM/3,000 SF sprinkler system
- + 1 dock high door
- + 1 grade level door
- + 200 amps, 120/208 volts, 3 phase
- + 48' x 48' typical bay spacing
- + 188' reciprocal trucking court and staging area
- + Secured, concrete truck court
- + Located within a foreign trade zone
- + Part of California Commerce Center

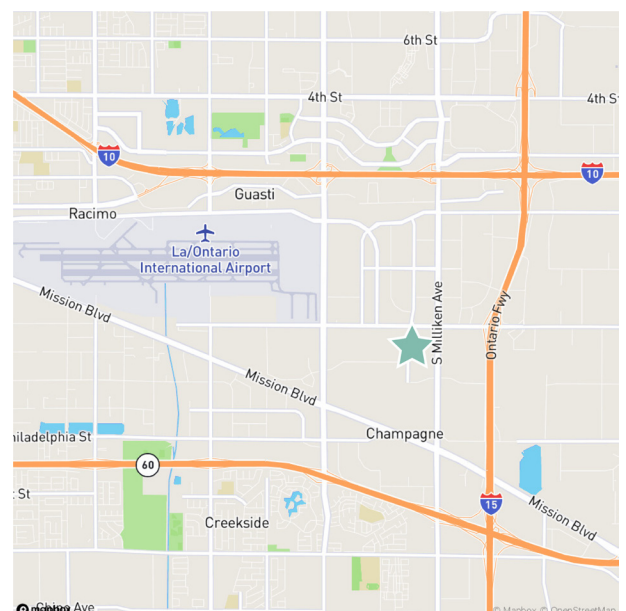

Contact Us

Len Santoro

+1 909 418 2158

len.santoro@cbre.com

Lic. 00758706

Wes Jones

+1 909 418 2070

wes.jones@cbre.com

Lic. 01783489

Ryan Athens

+1 909 418 2021

ryan.athens@cbre.com

Lic. 01387750

±6,960 SF AVAILABLE

1505 DUPONT AVE, SUITE F | ONTARIO, CA 91761

For Lease

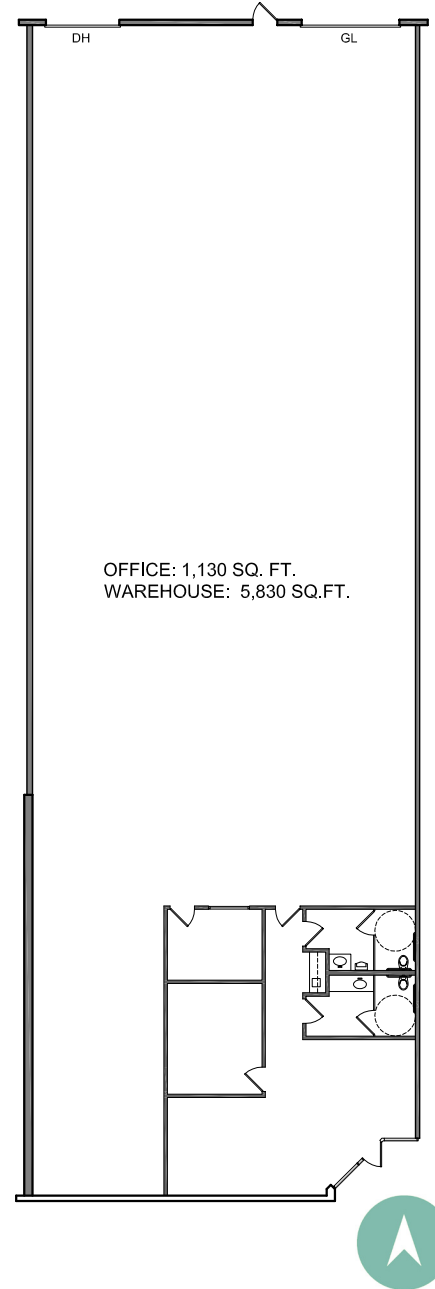
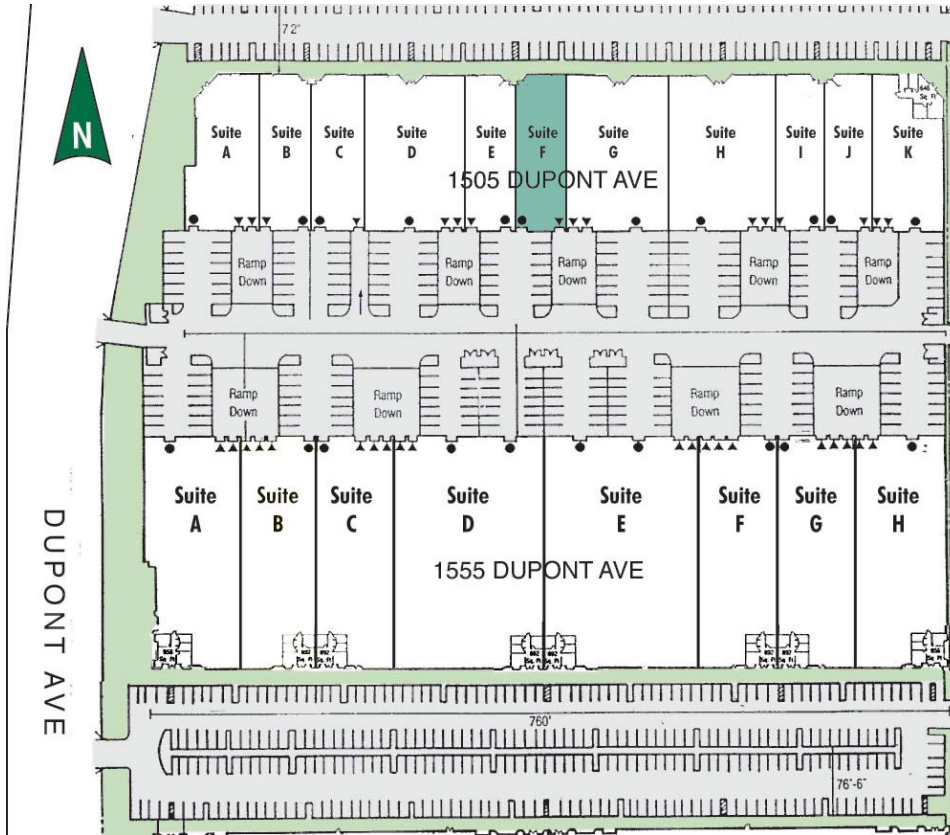

Contact Us

Len Santoro

+1 909 418 2158

len.santoro@cbre.com

Lic. 00758706

Wes Jones

+1 909 418 2070

wes.jones@cbre.com

Lic. 01783489

Ryan Athens

+1 909 418 2021

ryan.athens@cbre.com

Lic. 01387750

© 2022 CBRE, Inc. All rights reserved. This information has been obtained from sources believed reliable, but has not been verified for accuracy or completeness. You should conduct a careful, independent investigation of the property and verify all information. Any reliance on this information is solely at your own risk. CBRE and the CBRE logo are service marks of CBRE, Inc. All other marks displayed on this document are the property of their respective owners, and the use of such logos does not imply any affiliation with or endorsement of CBRE. Photos herein are the property of their respective owners. Use of these images without the express written consent of the owner is prohibited.

For Lease

CBRE

Dupont Industrial Center

1555 Dupont Ave, Suite G, Ontario, CA 91761

±15,696

SF AVAILABLE



Building Features

- + ±15,696 SF Industrial Building
- + ±957 SF of Office Space
- + 24' Clear Height
- + 0.45 GPM/3,000 SF sprinkler system
- + 3 Dock High Doors
- + 1 grade level door
- + 48' x 48' typical bay spacing
- + 188' reciprocal trucking court and staging area
- + Secured, concrete truck court
- + Located within a foreign trade zone
- + Part of California Commerce Center

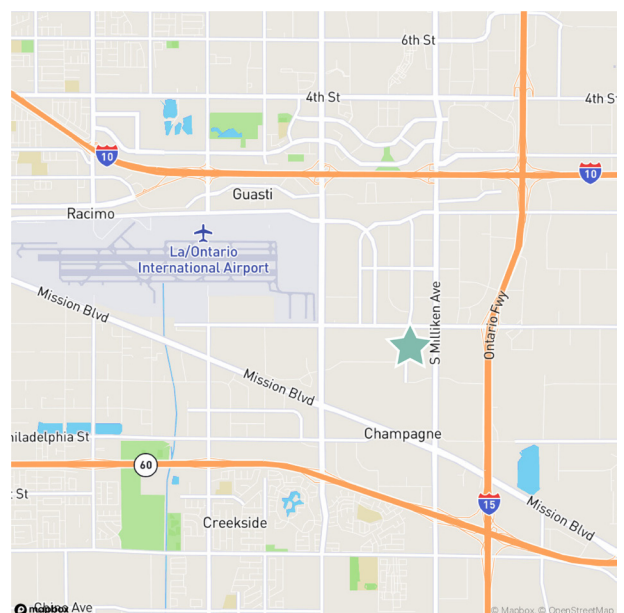

Contact Us

Len Santoro

+1 909 418 2158

len.santoro@cbre.com

Lic. 00758706

Wes Jones

+1 909 418 2070

wes.jones@cbre.com

Lic. 01783489

Ryan Athens

+1 909 418 2021

ryan.athens@cbre.com

Lic. 01387750

±15,696 SF AVAILABLE

1555 DUPONT AVE, SUITE G, ONTARIO, CA 91761

For Lease

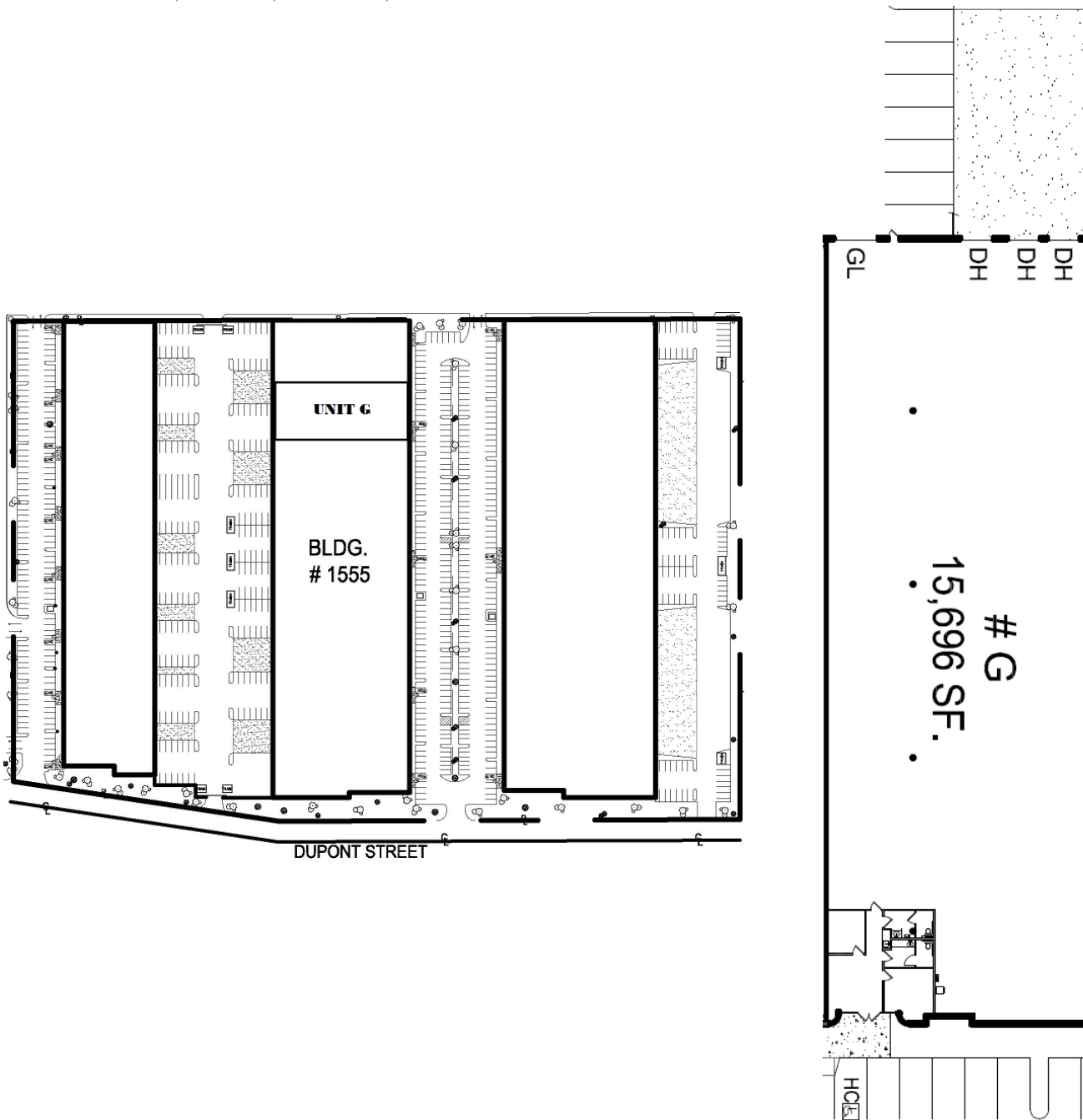

Contact Us

Len Santoro

+1 909 418 2158

len.santoro@cbre.com

Lic. 00758706

Wes Jones

+1 909 418 2070

wes.jones@cbre.com

Lic. 01783489

Ryan Athens

+1 909 418 2021

ryan.athens@cbre.com

Lic. 01387750

© 2024 CBRE, Inc. All rights reserved. This information has been obtained from sources believed reliable, but has not been verified for accuracy or completeness. You should conduct a careful, independent investigation of the property and verify all information. Any reliance on this information is solely at your own risk. CBRE and the CBRE logo are service marks of CBRE, Inc. All other marks displayed on this document are the property of their respective owners, and the use of such logos does not imply any affiliation with or endorsement of CBRE. Photos herein are the property of their respective owners. Use of these images without the express written consent of the owner is prohibited.